

Legi-Air AP182

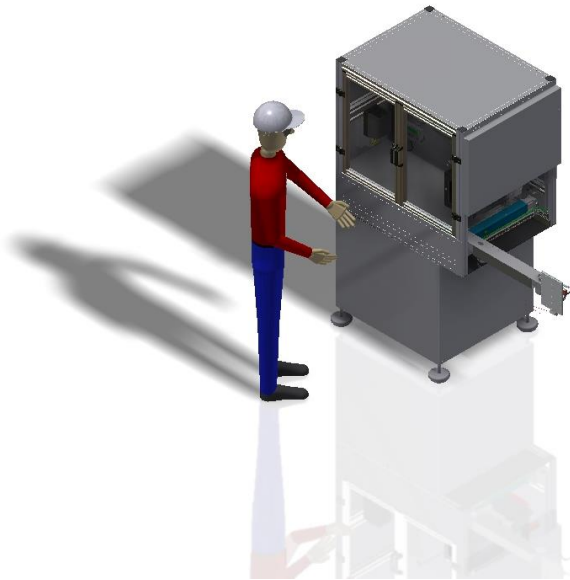

Technical Specifications:	
Printing Technology	Thermal transfer or direct thermal
Print Resolution	9 dots / mm (203 dpi) 12 dots / mm (300 dpi) 24 dots / mm (600 dpi)
Print Speed	Up to 400 mm per second
Label Size	Standard: GS1 Recommended sizes: DIN A5 (150 x 210), DIN A6 (100 x 150); optional: further sizes available
Tamp Size	150x220 mm
Label Gap	minimum 3 mm
Label Roll	350mm outside diameter with up to 600 m, core 76mm (3"), outside winding, low label prewarming
Data Interface	All current interfaces (details in prospect print engines)
Controller Interface	Volt free outputs (relays), opt coupler inputs,
Maintenance Interval	According to interval display
Performance Data	Up to 90 pallets/ h for 3-sided labeling Up to 120 pallets/ h for 2-sided labeling
Application Accuracy	± 2 mm on stopped pallet
Number of pallet stops	2 stops for 3-sided labeling according to GS1 1 Stop for double-sided labeling according to GS1
Speed without pallet stops	-
Print-Apply-Trigger	Volt free contacts (PLC)
Alarm System	Standard: error message in text display, volt free contact (PLC), optional: 3-coloured alarm lamp
Compressed Air Consumption	1 up to 3 l per pallet label, depending on label size and setting
Compressed Air Connection	6 bar, air pressure has to be dry and oil-free (DIN ISO 8573-1)
Weight	Up from 130 kg (depending on stand frame)
Power Connection	92 up to 263 VAC, 50/60 Hz, 5 Ampere
Environmental Conditions	Temperature: 10° C up to 35° C, 15 up to 95 % relative air humidity non condensing

Certification	CE-Confirmation, GS1 conform labeling
Options	Stand (special version for 182/180), RFID labeling Shutter and heating for very difficult environmental conditions IPC in protective housing LLS Legitronic® Labeling Software Bluhmware for controlling and networking the systems attendance check of labels scanner (1-D/2-D), Vision Systems, Sensors, RFID Gates stands in different versions (fixed, height adjustable, turnable)
Dimensions	W 731mm – L 1123mm Height depending on stand Height without stand 981mm

Distribution arguments depending on system

- print engine technology of leading global manufacturers
- very compact 3-side labeler which needs only 2 pallet stops for 3-sided labeling
- Europe-wide distribution
- large label rolls 350 mm diameter
- developed for day and night operation
- all components and also spare parts are standard and originated from large-volume production
- no safety guarding necessary
- gap scanner or scanner on tamp available
- simple and well-arranged system structure enables the customer`s technicians quick self-help measures in case of errors
large consultant and service network

Technical Specifications (in detail):	
Stand necessary	Individual base frame on request (depends on application height)
Protective Housing	Standard
Material of Housing	aluminum profile with stainless steel plate
Controller	micro controller
Festo Pneumatic	100%
Gauge	-
Mechanical Components	metric
Modules / Replacement-Assemblies	No
Display Lighting	background lighting
(Remote) Display Remote mountable	no
Power Unit for Applicator	Electrical
Multilingual Display-Menue	GB, F, I
Detailed Status and Error Messages	standard
Diagnostic Function Diagnosis Monitor	standard
Service/Maintenance Counter Service Message	-
Safety Guarding necessary	No (standard version)
Printer	flexible print engine technology: Datamax, Sato, Zebra, Avery, CAB
LH / RH	yes, at the same price
Max. Tamp (mm)	160 x 220
Max. Label (mm)	160 x 210
Min. Tamp (mm)	160 x 220
Min. Label (mm)	50 x 50
Max. Front Stroke (length of swinging arm)	545
Max. Stroke (useable; optional)	745 (linear)

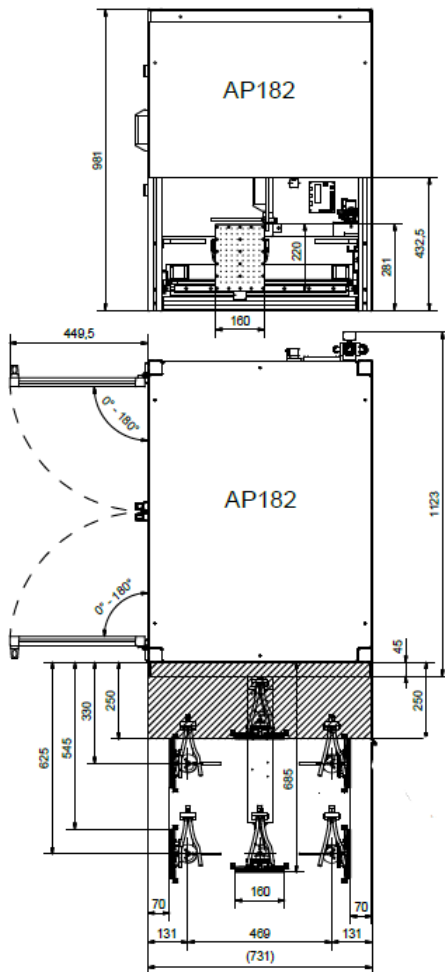

Recommended continuous power rating with max. stroke standard applicator PPM=products per minute	3-shift, because of robust applicator construction no limitation for continuous operation
Labeling without stop possible (max. speed in case of euro-pallet)	no
Labeling in stop possible (number of necessary stops)	1 or 2
Top performance for 2 sides	120 pal. / h
3-side Labeling possible (number of stops)	2
Top performance 3 sides (stopped)	90 pal. / h
Change Application Mode (front, side, front and side) per pallet	Standard (via signal)
Tolerance of Label Position (stopped)	± 2 mm
2 Product Sensors incl. mounting	standard
Product Sensor Configuration NPN/PNP	via jumper
Possibilities of configuration via PC	-
Signal exchange to customer via volt free contact	standard
Max. Roll Diameter	350 mm
Max. Run Width	150 mm
Unwind Discs	standard

Rewind (stepper motor technique)	standard
Spring loaded Tamp	standard
Variable Product Detection	1 x optical,
Low Label Prewarning	standard
Control Label on Tamp Pad	standard
2-level Vacuum	standard
Service – Export Possibility	D, A, CH, I, P
Alarm lamp	optional
Pressure Check	standard
Gap Scanner	option
Scanner on Tamp	option
Heating	option
Shutter for Tamp	standard electrical

AP180 vs AP182:

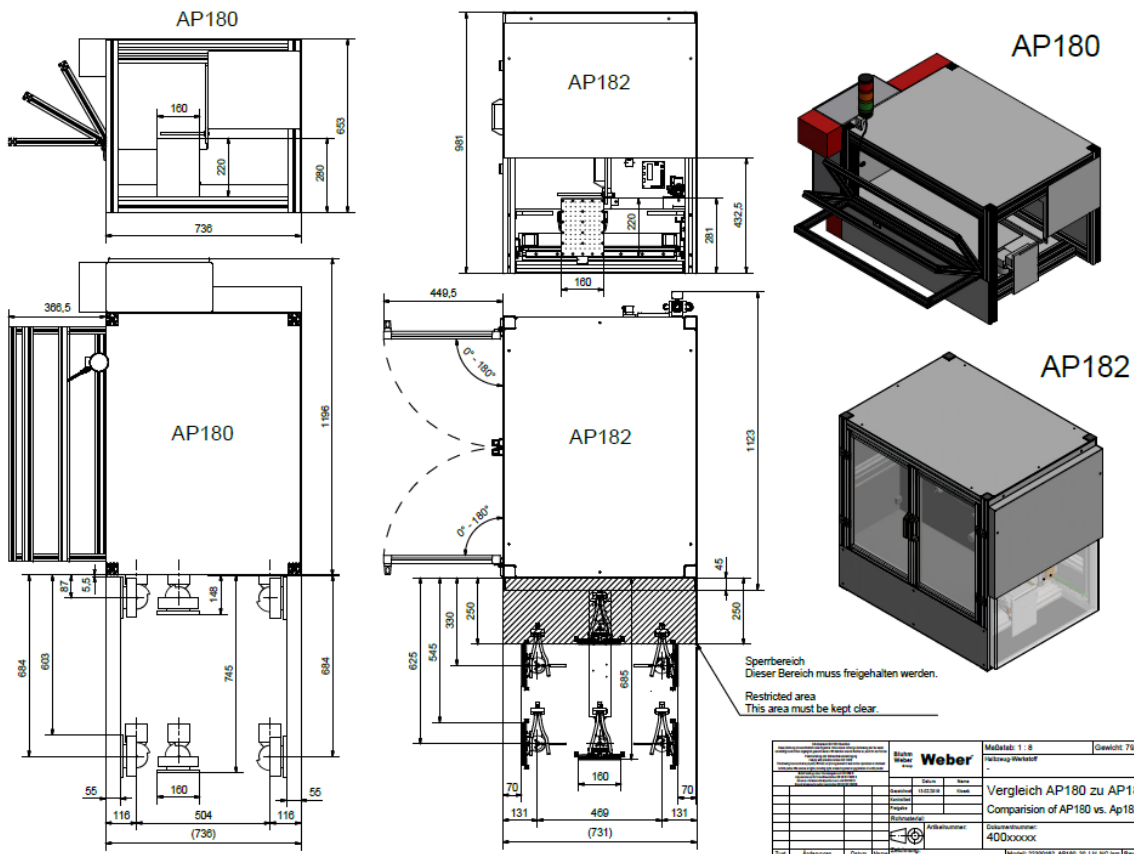

Bluhm Weber Group		Weber		Modellnr. 1 : 8		Gewicht: 79,19 kg	
Vergleich AP180 zu AP182		Comparison of AP180 vs. Ap182		400xxxxxx		1/1	
Date: 08/10/2019		Date: 08/10/2019		Modell: 2220182_AP180_36_LH_3D.kan		Revision:	